



PENSTOCKS
DAMPERS



CHANNEL PENSTOCK 3 SIDE SEALED - CCA - "General information"

Industrial area "Asteasu", sector A pavillon 4, 20159, ASTEASU (GIPUZKOA) SPAIN Tel: (+34) 943 69 61 31 Fax:(+34) 943 69 62 39

Bidapro -CCA- is a 3 side sealed penstock projected to be embedded in wall for controlling or directing the flow of a channel.

Mainly used for the following applications:

Waste water treatment plants

Drain manifolds

Hydroelectric power plants

Storm tanks

Desalination installations

Irrigation installations

Standard product dimensions range from 200x200 to 2000x2000 and standard model is supplied with the following characteristics:

Unidirectional

Rising stem

Designed to be embedded

Other options upon request: - bidirectional; - non rising stem; - for wall mounting; - for side mounting

Leakage rate according to ANSI / AWWA C 513-05

High density polyethylene sliders to minimize friction coefficient

Frame: carbon steel / AISI 304 / AISI 316

Plate: carbon steel / AISI 304 / AISI 316

Sliders: high density polyethylene

Materials: Column: carbon steel / AISI 304 / AISI 316

Extension and Guides: carbon steel / AISI 304 / AISI 316

Spindle: AISI 303 / AISI 304 / AISI 316

Nut: bronze

Seat: EPDM / Nitrile

Other materials upon request

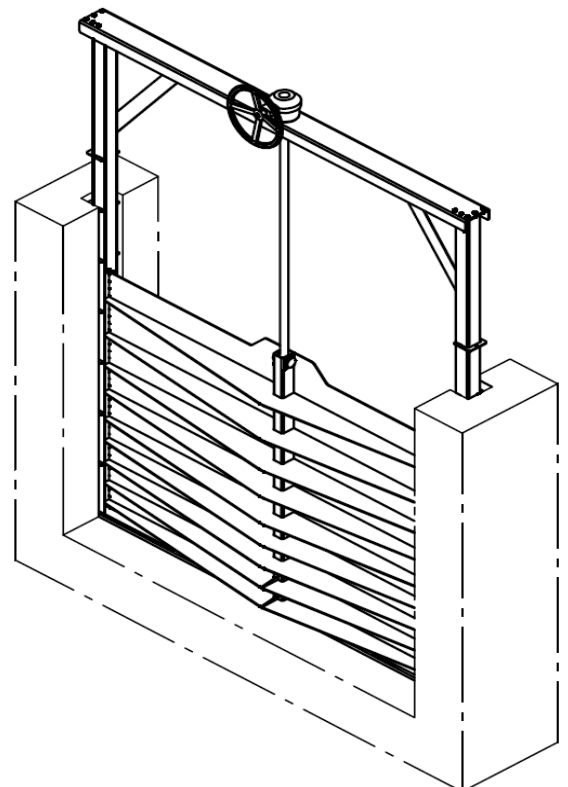



PENSTOCKS
DAMPERS



CHANNEL PENSTOCK 3 SIDE SEALED - CCA -
"Dimensions and Actuators"

Industrial area "Asteasu", sector A pavillon 4, 20159, ASTEASU (GIPUZKOA) SPAIN Tel: (+34) 943 69 61 31 Fax:(+34) 943 69 62 39

DIMENSIONS FROM 200X200 TO 2000X2000

AXB	C	D
200X200	324	416
300X300	424	616
400X400	524	816
500X500	624	1016
600X600	724	1216
700X700	824	1416
800X800	924	1616
900X900	1024	1816
1000X1000	1124	2016
1100X1100	1224	2220
1200X1200	1324	2420
1300X1300	1424	2620
1400X1400	1524	2955
1500X1500	1650	3225
1600X1600	1750	3425
1700X1700	1850	3625
1800X1800	1950	3825
1900X1900	2050	4025
2000X2000	2150	4225

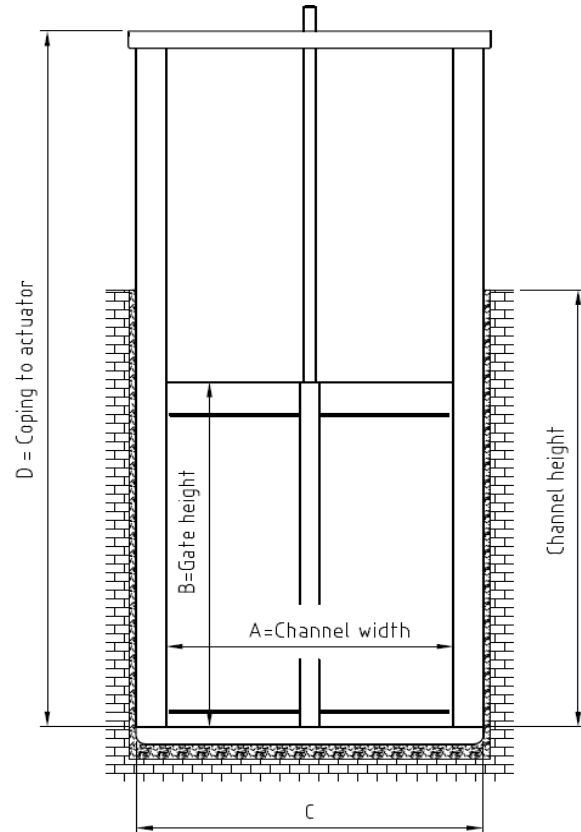

Electric Motor Pneumatic Gear Box Handwheel Non rising handwheel Square nut Hydraulic

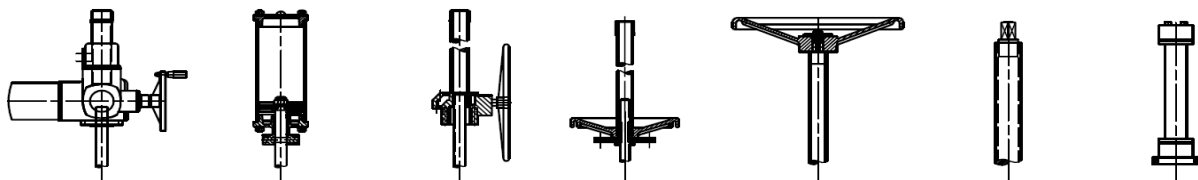

Bidapro reserves the rights to change dimensions at any time without prior notice



PENSTOCKS
DAMPERS



CHANNEL PENSTOCK 3 SIDE SEALED - CCA -
"Preparing installation"

Industrial area "Asteasu", sector A pavillon 4, 20159, ASTEASU (GIPUZKOA) SPAIN Tel: (+34) 943 69 61 31 Fax:(+34) 943 69 62 39

Lateral holes' dimensions for CCA $\leq 1000 \times 1000$

Bottom hole's dimensions for CCA $\leq 1000 \times 1000$

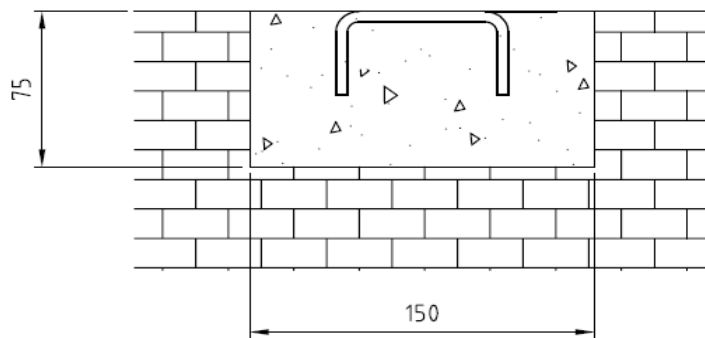
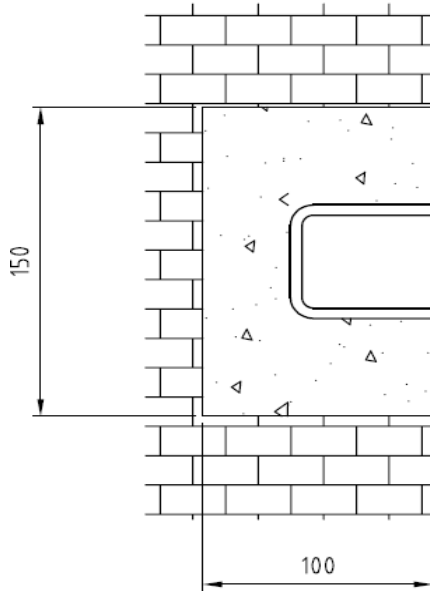

Lateral and bottom holes' dimensions for CCA $> 1000 \times 1000$ and $\leq 2000 \times 2000$

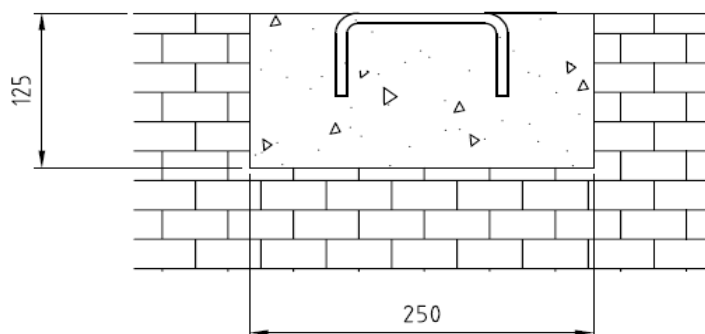
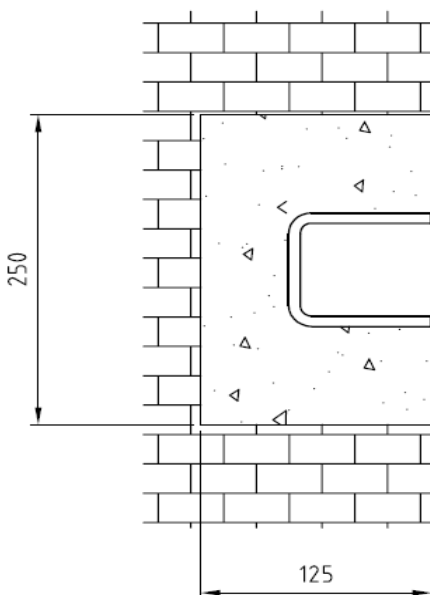



PENSTOCKS
DAMPERS



CHANNEL PENSTOCK 3 SIDE SEALED - CCA - "Installation and maintenance"

Industrial area "Asteasu", sector A pavillon 4, 20159, ASTEASU (GIPUZKOA) SPAIN Tel: (+34) 943 69 61 31 Fax:(+34) 943 69 62 39

Installation

- Be careful unloading the assembly, then place the frame in the appropriate space previously prepared following page 3 instructions, with the seat against the flow direction;
- Level the penstock while embedding it, taking care to not create an obstacle to the flow ;
- Once levelled, use penstock's claws to weld it to the metal concrete reinforcements (if exist) or use some wood to help you fix penstock in its appropriate position, while you'r pouring the cement (SilkagROUT or similar);
- Cover the holes with some boards and pour cement;
- Let the concrete become dry and verify its correct position;
- Clean penstock before start to operate on it.
- **Bidapro does not take any responsibility for a penstock not installed correctly**

Maintenance

- Check the EPDM seat and change it in case of deterioration;
- Check the high density polyethylene sliders are in good condition and change them in case of deterioration. Keep the screwed part of the stem (spindle) and the actuator clean.

Routine operations

- Opening and closing:
 - to open: turn the handwheel anticlockwise;
 - to close: turn the handwheel clockwise. Do not apply unnecessary force while closing the penstock.





PENSTOCKS
DAMPERS



CHANNEL PENSTOCK 3 SIDE SEALED - CCA -
"Quotations data"

Industrial area "Asteasu", sector A pavillon 4, 20159, ASTEASU (GIPUZKOA) SPAIN Tel: (+34) 943 69 61 31 Fax:(+34) 943 69 62 39

Quantity

-

Channel dimensions

- Width mm
- Length mm

Gate height

- "C"..... mm

Coping to actuator

- "D"..... mm

Water height

- mm

Fluid direction

- Unidirectional
- Bidirectional

Stem

- Rising stem
- Non rising stem

Material

- AISI 304
- AISI 316
- Carbon steel
- Others

Actuator

- Handwheel
- Gearbox
- Electric motor
- Hydraulic
- Pneumatic
- T key
- Others

Actuator support

- Straight column
- On the frame

